

*Take advantage of International Fluid Power's industry leading prices on our full product line*



LS5000 series manually operated directional valve is a direct type directional valve. It can be used to change the direction of hydraulic oil lines, allowing the spool to move in axial direction by adjusting the handle. It adopts ball positioner or spring as restoring device.

**STANDARD VALVES AVAILABLE:**

Order Code	Work port size	In/out port size
LS5000-1	1/2" NPTF	3/4" NPTF
LS5000-2	3/4" NPTF	3/4" NPTF

\* Custom-made ports available

**STANDARD FEATURES:**

- The monoblock casting body of high tensile strength ductile iron
- Hydraulically balanced, hard chrome plated spool
- In neutral position, both work ports blocked, pump unloaded to tank
- Ideal for log splitter applications. Available with 3/4" PTF work ports for higher flow applications

**PRESSURE RELEASE DETENT**

This feature provides a pressure release detent for the spool 'out' (hand in) position. When the spool is manually placed in the detent position oil is directed to the 'B' port ( the port away from the handle). When the pressure in the 'B' port reaches a preset level the detent will release and the spool will center. INTERNATIONAL fpa setting is 1400 PSI (97bar). The screw clockwise will increase the detent release pressure is adjustable by loosening the jam nut and turning the adjusting screw. Turning the adjusting screw clockwise will increase the detent release pressure and counterclockwise will decrease the detent release pressure.

**NOTE:** if the detent release pressure is set too high the spool will not center. If the pressure is too low the detent will not hold. If cap screw item 6 becomes loose detent will not function properly.

**RELIEF VALVE**

An adjustable ball spring relief valve is standard on all LS5000 valves. The standard INTERNATIONAL fpa setting is 2200PSI (152bar) @ 3 GPM (11.4L/min) and 120°F (48.9°C). Oter settings can be specified. The relief pressure is adjusted by removing acorn nut, and turning the adjusting screw. Turning the adjusting screw clockwise will increase the pressure and counterclockwise will decrease the pressure (a pressure gauge must be installed in the inlet line whenever the relief pressure is adjusted). Do not back out adjusting screw to the point it fails out.

**WARNING!**

**OVERPRESSURE MAY CAUSE SUDDEN AND UNEXPECTED FAILURE OF A COMPONENT IN THE HYDRAULIC SYSTEM RESULTING IN SERIOUS PERSONAL INJURY. ALWAYS USE A GAUGE WHEN ADJUSTING A RELIEF VALVE.**

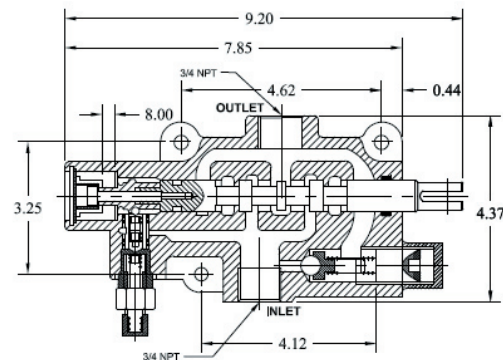
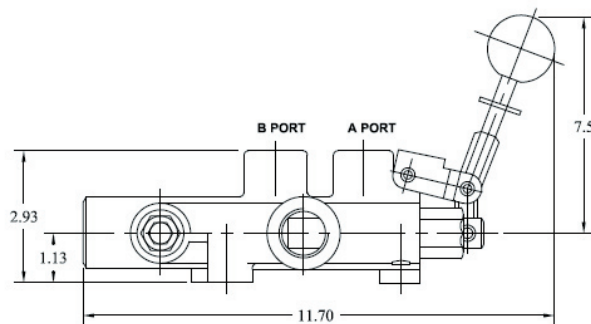

43105 Business Park Drive  
Temecula, CA 92590 USA

**COAST TO COAST LOCATIONS**  
TO BETTER SERVICE YOUR REQUIREMENTS

4600 Garand, Montreal  
Qc H4R 2A2 Canada

West Coast Toll Free (800) 432-6405  
Visit our updated Website: [www.intlfpa.com](http://www.intlfpa.com)

Toll Free Phone (888) 220-1414  
Toll Free Fax (888) 220-1415

East Coast Toll Free (800) 363-8446  
E-Mail: [info@intlfpa.com](mailto:info@intlfpa.com)