

# IFP T6DC DOUBLE PUMP SERVICE PARTS INFORMATION

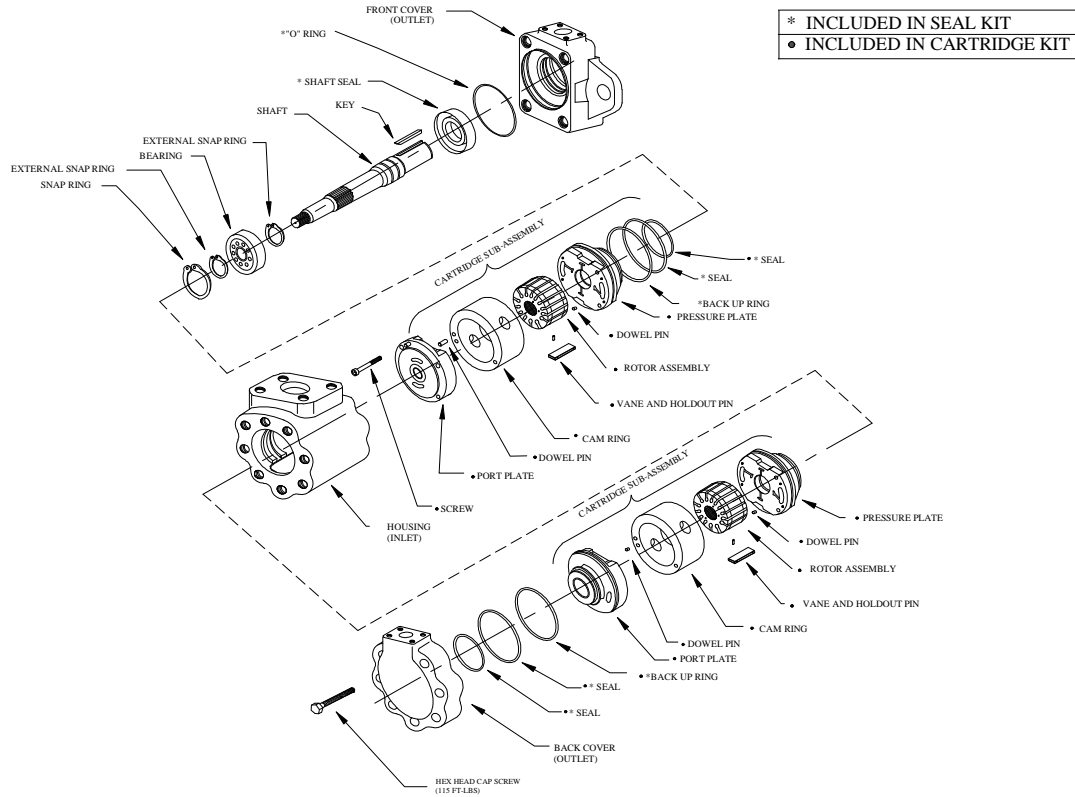

## CARTRIDGE CHART

PUMP SIZE	FRONT CART. KIT	CAM(T6D) RING	PUMP SIZE	BACK CART. KIT	CAM(T6C) RING	VANE KIT	ROTOR	PRESSURE PLATE	PORT PLATE	SHAFT	
T6D-014	S24-40791N	034-66708N	T6C-003	S24-10767N	034-59050N	034-53588N	S24-10121N	034-59808N	034-59810N	#1	034-71363N
T6D-020	S24-26490N	034-66596N	T6C-005	S24-10769N	034-59051N	(FRONT	(FRONT	(FRONT	(FRONT	#2	034-71364N
T6D-024	S24-25891N	034-59294N	T6C-006	S24-10171N	034-59052N	VANE KIT)	(FRONT	(FRONT	(FRONT	#3	034-71361N
T6D-028	S24-10849N	034-59113N	T6C-008	S24-10773N	034-59053N		CART. KIT)	CART. KIT)	CART. KIT)	#4	034-66578N
T6D-031	S24-10851N	034-59135N	T6C-010	S24-10775N	034-59054N	034-59099N					
T6D-035	S24-10853N	034-59137N	T6C-012	S24-26480N	034-66595N	(BACK	S24-10116N	034-59772N	034-59774N		
T6D-038	S24-10855N	034-59139N	T6C-014	S24-10777N	034-59206N	VANE KIT)	(BACK	(BACK	(BACK		
T6D-042	S24-10857N	034-59132N	T6C-017	S24-10779N	034-59207N		CART. KIT)	CART. KIT)	CART. KIT)		
T6D-045	S24-10859N	034-59131N	T6C-022	S24-10781N	034-59208N						
T6D-050	S24-40236N	034-66737N	T6C-025	S24-10783N	034-59209N						
			T60-028	S24-97722N	034-59245N						

**- All cartridge assemblies are factory tested prior to shipping -**

STANDARD SEAL KIT	VITON SEAL KIT	STANDARD SHAFT SEAL	VITON SHAFT SEAL	BEARING	FRONT COVER	BACK COVER	HOUSING COVER
S24-10170-0-N	S24-10170-0-N	620-82062N	620-82062N	230-00207N	034-48135	034-48579	034-48133

## Filtration

For satisfactory service life, use full flow filtration to provide fluid which meets ISO cleanliness code 16/13 or better.