

IFP V2010 DOUBLE VANE PUMP SERVICE PARTS INFORMATION

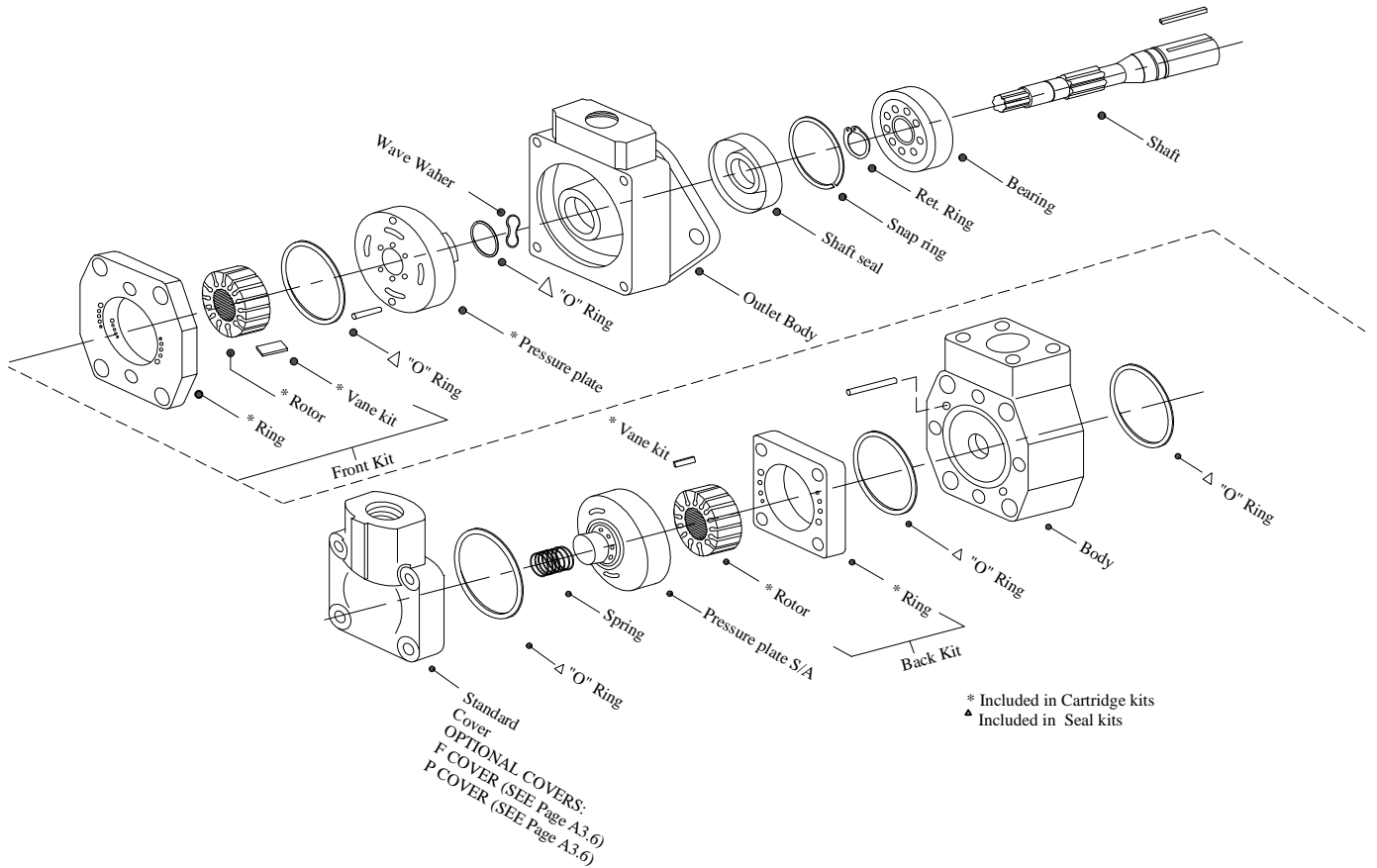

PUMP SE	FRONT C. KIT	FRONT ROTOR	FRONT VANE	FRONT RING	FRONT PR. PL.	BACK C. KIT	BACK ROTOR	BACK VANE	BACK RING	BACK PR. PL.
V2010	6 923474N	358339N	923485N	328150N	913569N	1 923471N	317681N	923499N	317674N	373795N
	7 923494N	358335N	923493N	328152N		2 923470N			317675N	
	8 923495N			331791N		3 923496N			317676N	
	9 923462N			331789N		4 923469N	351247N	923500N	317677N	
	11 923475N	358336N	923478N	328156N		5 923468N			317678N	
	12 923476N	358337N	923479N	331806N		6 923497N	357286N	923501N	355641N	
	13 923477N			331807N		7 923498N			331813N	

PUMP SE	SEAL KIT	SEAL	BEARING	BODY	SHAFT NO.	OUTLET BODY
V2010	923577N	229236N	82938N	357292N	SHAFT I. NO. 351249N SHAFT II. NO. 321215N	850224N

- All Cartridge assemblies are factory tested before shipping -

Bolt Torques

	FRONT SECTION	BACK SECTION
V2010	85 LBS/FT.	45 LBS/FT.

Changing Cartridge Rotation

Reposition the ring 90° from its original position using the locating pins for alignment, making sure that the arrow on the perimeter points in the proper direction of rotation. Install the rotor on the shaft and insert vanes in the rotor slots. Be certain that the radius edges of the vanes are towards the cam ring.