

IFP V2020 DOUBLE VANE PUMP SERVICE PARTS INFORMATION

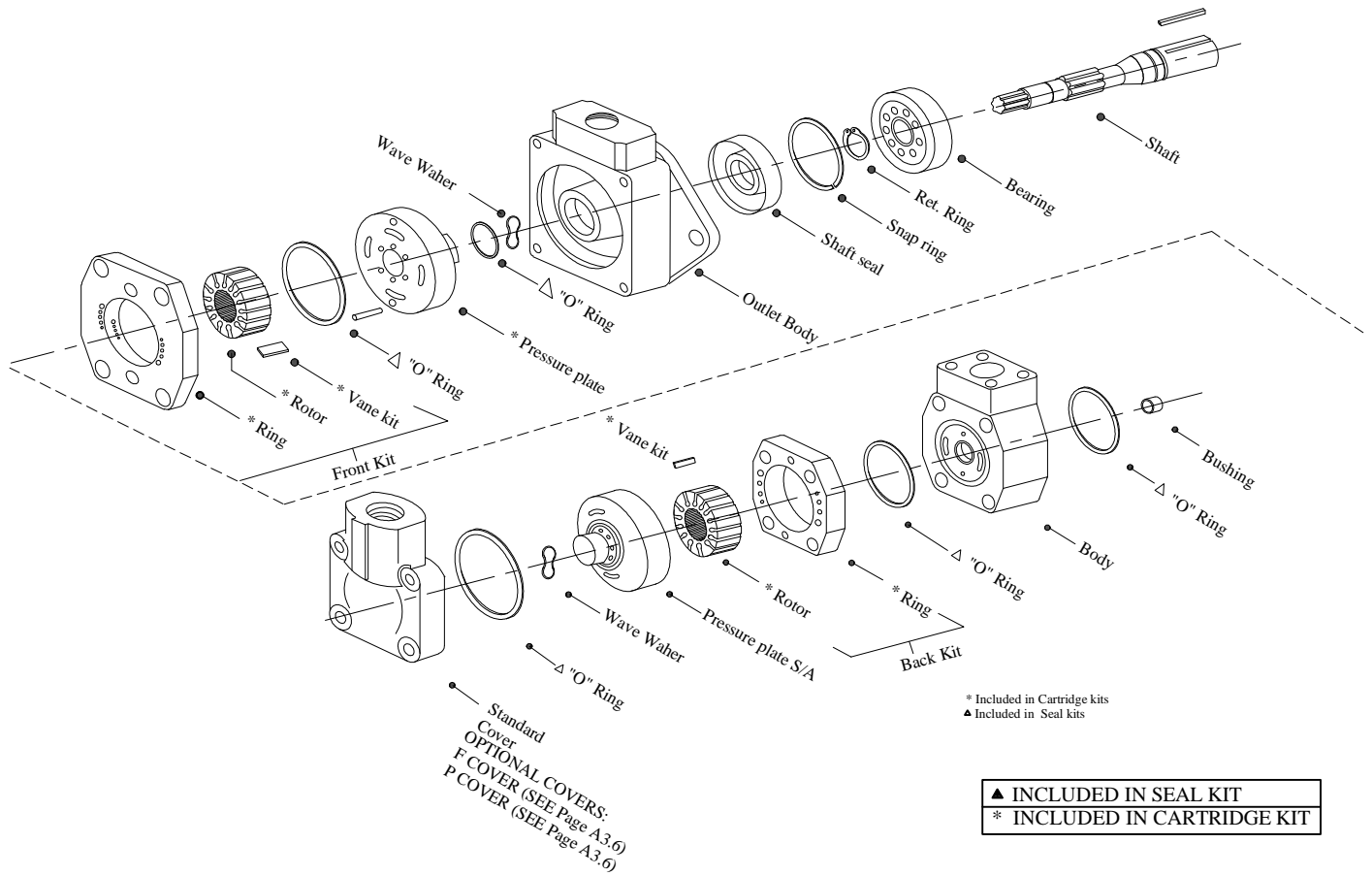

PUMP SE	FRONT C. KIT	FRONT ROTOR	FRONT VANES	FRONT RING	FRONT PR. PL.	BACK C. KIT	BACK ROTOR	BACK VANES	BACK RING	BACK PR. PL.
V2020	6 923474N	358339N	923485N	328150N	913569N	6 923480N	358328N	923485N	328150N	913529N
	7 923494N	358335N	923493N	328152N		7 923481N	358330N	923493N	328152N	
	8 923495N			331791N		8 923483N			331791N	
	9 923462N			331789N		9 923484N			331789N	
	11 923475N	358336N	923478N	328156N		11 923482N	358332N	923478N	328156N	
	12 923476N	358337N	923479N	331806N						
	13 923477N			331807N						

PUMP SE	SEAL KIT	SEAL	BEARING	BODY	SHAFT NO.	OUTLET BODY
V2020	923174N	229236N	82938N	308681N	SHAFT 1. NO. 308686N	850224N
					SHAFT 11. NO. 308926N	

- All Cartridge assemblies are factory tested before shipping -

Bolt Torques

	FRONT SECTION	BACK SECTION
V2020		81 LBS/FT.

Changing Cartridge Rotation

Reposition the ring 90° from its original position using the locating pins for alignment, making sure that the arrow on the perimeter points in the proper direction of rotation. Install the rotor on the shaft and insert vanes in the rotor slots. Be certain that the radius edges of the vanes are towards the cam ring.