

# IFP DGSP07 SUBPLATES

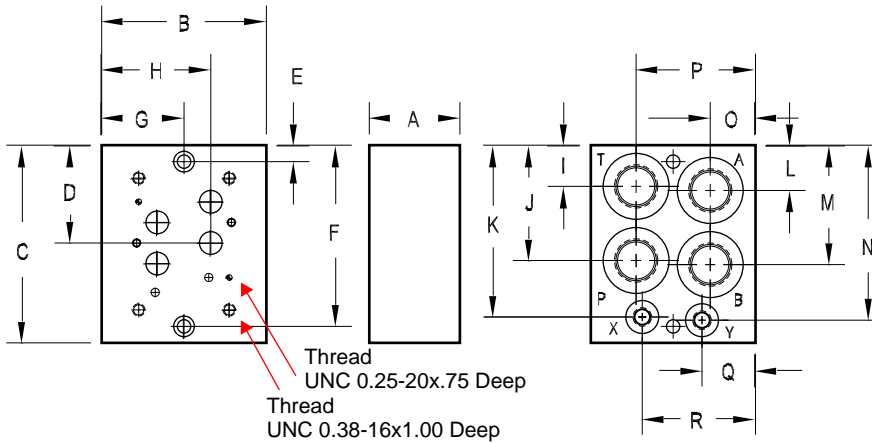

## DG07 Back Ported Subplate

Model	A	B	C	D	E	F	G	H	I	J	K	L	M	N	O	P	Q	R
<b>DGSP07 S12</b>	1.50	4.00	4.75	2.34	.38	4.38	2.00	2.81	1.09	2.75	4.00	1.19	2.81	4.09	1.12	2.94	1.13	2.94
<b>DGSP07 N12</b>	(38.1)	(101.1)	(120.7)	(59.4)	(9.5)	(111.3)	(50.8)	(71.4)	(27.7)	(69.9)	(101.6)	(30.2)	(71.4)	(103.9)	(28.4)	(74.7)	(28.7)	(74.7)
<b>DGSP07 S16</b>	2.75	5.00	6.00	2.97	.50	5.50	2.50	3.31	1.25	3.50	5.31	1.38	3.63	5.31	1.38	3.63	1.63	3.44
<b>DGSP07 N16</b>	(69.9)	(127.0)	(152.4)	(75.4)	(12.7)	(139.7)	(63.5)	(84.2)	(31.8)	(88.9)	(134.9)	(34.9)	(92.1)	(134.9)	(34.9)	(92.1)	(41.3)	(87.3)



Model code	Ports P,T,A,B	Ports X&Y
<b>DGSP07 S12</b>	-12 SAE	-6 SAE
<b>DGSP07 N12</b>	3/4 NPT	1/4 NPT
<b>DGSP07 S16</b>	-16 SAE	-6 SAE
<b>DGSP07 N16</b>	1" NPT	1/4 NPT

## DG07 Side Ported Subplate

Model	A	B	C	D	E	F	G	H	I	J	K	L	M	N	O	P
<b>DGSP07 S12E</b>	1.75	3.75	4.75	2.34	.38	4.38	1.88	2.69	.81	1.50	3.13	1.19	2.78	1.25	1.12	2.62
<b>DGSP07 N12E</b>	(44.5)	(95.3)	(120.7)	(59.4)	(9.5)	(111.3)	(47.8)	(68.3)	(20.6)	(38.1)	(79.5)	(30.2)	(70.6)	(31.8)	(28.4)	(66.5)
<b>DGSP07 S16E</b>	3.00	5.00	5.50	2.97	.50	5.00	2.50	3.31	1.19	1.81	4.13	1.19	3.50	2.38	1.75	3.25
<b>DGSP07 N16E</b>	(76.2)	(127.0)	(139.7)	(75.4)	(12.7)	(127.0)	(63.5)	(84.2)	(30.2)	(46.0)	(104.8)	(30.2)	(88.9)	(60.3)	(44.5)	(82.6)

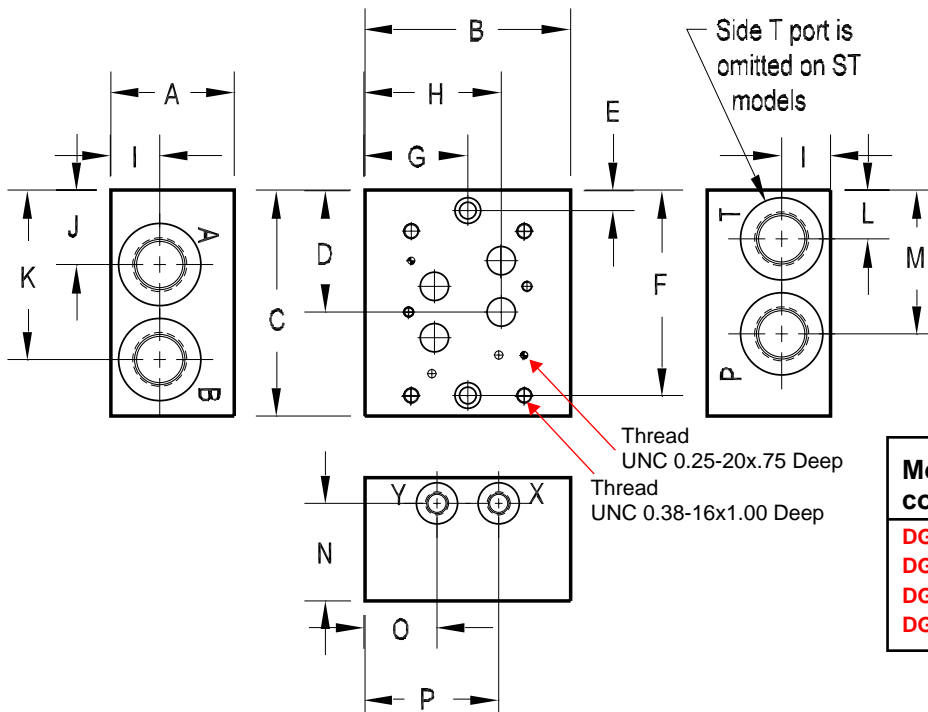

Model code	Ports P,T,A,B	Ports X&Y
<b>DGSP07 S12E</b>	-12 SAE	-6 SAE
<b>DGSP07 N12E</b>	3/4 NPT	1/4 NPT
<b>DGSP07 S16E</b>	-16 SAE	-6 SAE
<b>DGSP07 N16E</b>	1" NPT	1/4 NPT