

IFP DGSP08 SUBPLATES

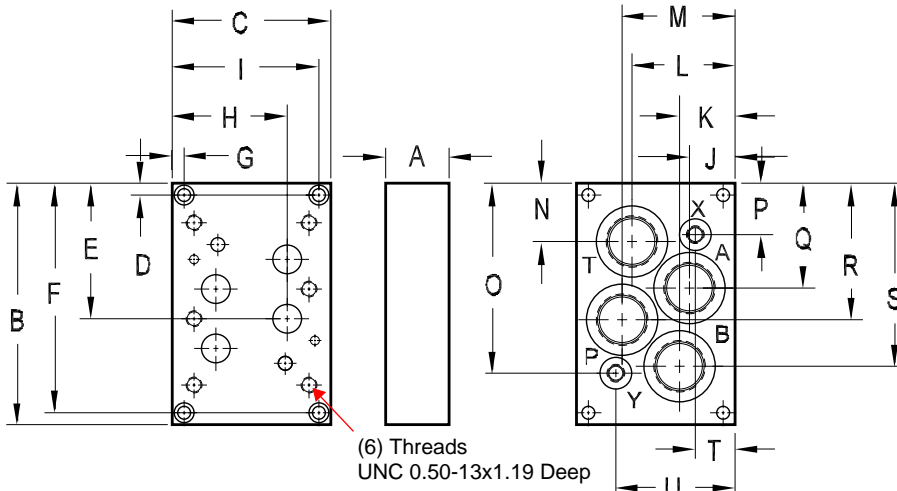

DG08 Back Ported Subplate

Model	A	B	C	D	E	F	G	H	J	K	L	M	N	O	P	Q	R	S
DGSP08 S12	1.50	6.13	4.63	.50	3.53	5.62	2.31	3.44	1.19	1.19	3.44	3.44	1.66	4.94	1.19	2.59	3.53	4.47
DGSP08 N12	(38.1)	(155.7)	(117.6)	(12.7)	(89.7)	(142.7)	(58.7)	(87.4)	(30.2)	(30.2)	(87.4)	(87.4)	(42.2)	(125.5)	(30.2)	(62.7)	(92.9)	(113.5)
DGSP08 S16	1.50	6.13	4.63	.50	3.53	5.62	2.31	3.44	1.19	1.19	3.44	3.44	1.53	5.16	0.97	2.47	3.66	4.59
DGSP08 N16	(38.1)	(155.7)	(117.6)	(12.7)	(89.7)	(142.7)	(58.7)	(87.4)	(30.2)	(30.2)	(87.4)	(87.4)	(38.9)	(131.0)	(30.2)	(65.8)	(92.9)	(116.7)



Model code	Ports P,T,A,B	Ports X&Y
DGSP08 S12	-12 SAE	-6 SAE
DGSP08 N12	3/4 NPT	1/4 NPT
DGSP08 S16	-16 SAE	-6 SAE
DGSP08 N16	1" NPT	1/4 NPT

DG08 Side Ported Subplate

Model	A	B	C	D	E	F	G	H	I	J	K	L	M	N	O	P
DGSP08 S12E	2.00	6.13	4.50	1.19	2.53	4.53	1.00	1.00	.50	3.53	5.62	2.25	3.38	1.56	3.59	4.94
DGSP08 N12E	(50.8)	(155.7)	(114.3)	(30.2)	(64.3)	(115.1)	(25.4)	(25.4)	(12.7)	(89.7)	(142.7)	(57.2)	(85.9)	(39.7)	(91.2)	(125.5)
DGSP08 S16E	2.00	6.13	4.50	1.19	2.53	4.53	1.00	1.00	.50	3.53	5.62	2.25	3.38	1.56	3.59	4.94
DGSP08 N16E	(50.8)	(155.7)	(114.3)	(30.2)	(64.3)	(115.1)	(25.4)	(25.4)	(12.7)	(89.7)	(142.7)	(57.2)	(85.9)	(39.7)	(91.2)	(125.5)

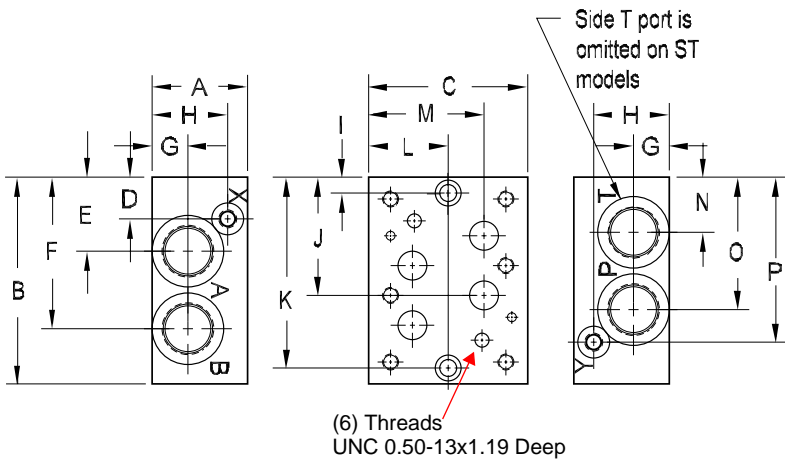

Model code	Ports P,T,A,B	Ports X&Y
DGSP08 S12E	-12 SAE	-6 SAE
DGSP08 N12E	3/4 NPT	1/4 NPT
DGSP08 S16E	-16 SAE	-6 SAE
DGSP08 N16E	1" NPT	1/4 NPT