

# IFP IP3300 PUMPS SERVICE PARTS INFORMATION

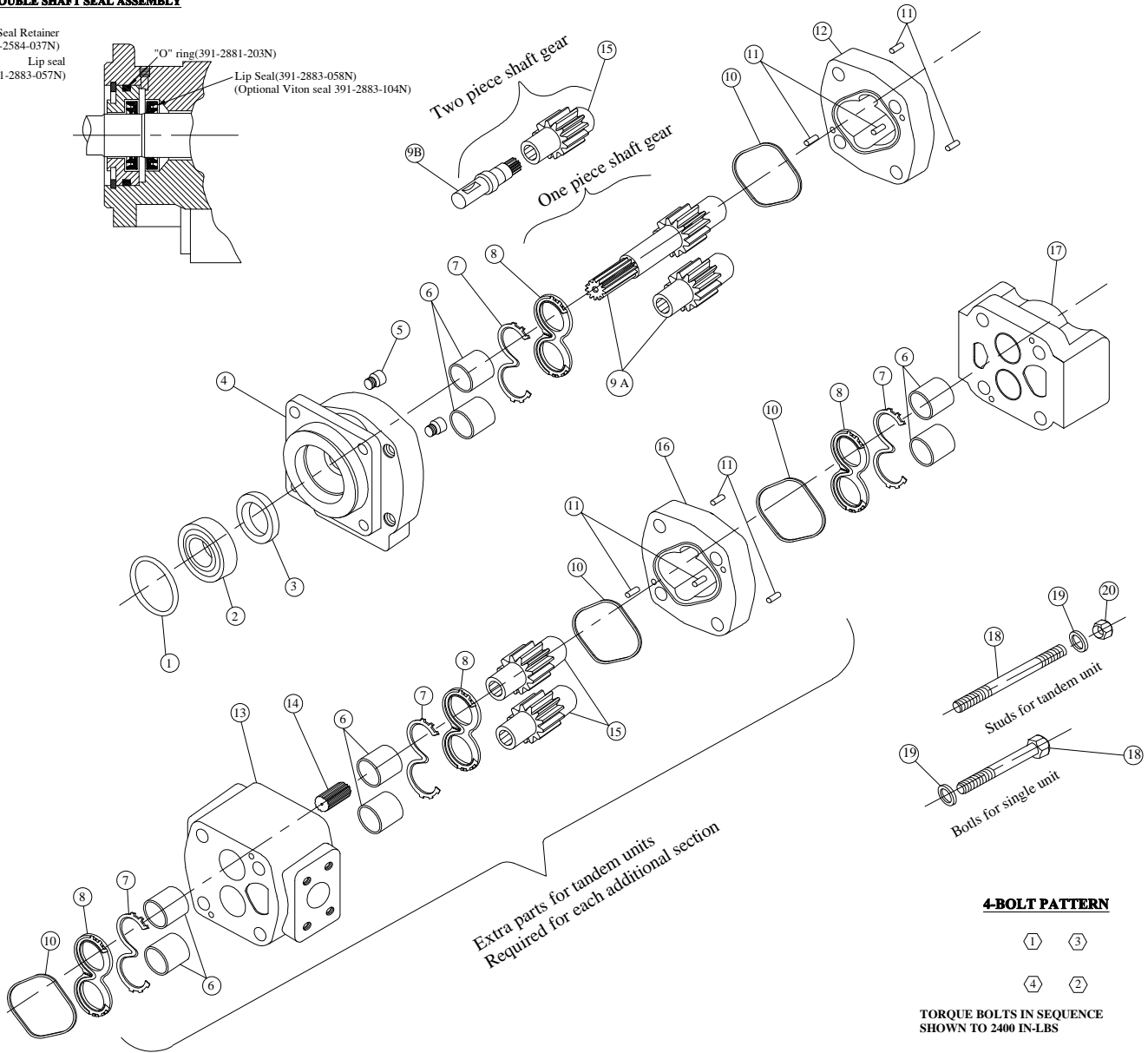

## DOUBLE SHAFT SEAL ASSEMBLY

Seal Retainer  
(391-2584-037N)  
Lip seal  
(391-2883-057N)

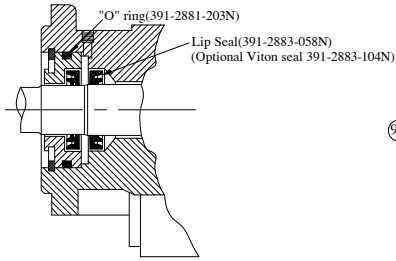

Extra parts for tandem units  
Required for each additional section

### 4-BOLT PATTERN



TORQUE BOLTS IN SEQUENCE  
SHOWN TO 2400 IN-LBS

## DESCRIPTION & CODES

ITEM	DESCRIPTION	REQ'S	PART NO.	ITEM	DESCRIPTION	REQ'S	PART NO.
1	SNAP RING	1	391-2686-063 N	11	DOWEL PINS	4 or more	391-2082-032N
2	OUTBOARD BEARING	1	391-0381-040N	12	GEAR HOUSING	1	324-81xx-100N
3	SEAL	1	391-2883-058N	13	BEARING CARRIER	1	324-7xxx-100N
4	SHAFT END COVER	1	324-5xxx-xxxN	14	CONNECTING SHAFT	1	324-1133-001N
5	PLUG	2	391-2286-004N	15	MATCHED GEAR SET	1	324-28xx-000N
6	BUSHINGS	4 or more	391-0482-306N	16	GEAR HOUSING	1	324-81xx-100N
7	CHANNEL SEAL	4 or more	391-2885-065N	17	PORT END COVER	1	324-3xxx-100N
8	THRUST PLATES	4 or more	391-2185-956N	18	CAP SCREWS & STUDS	4	xx-BOLTS-xx IN
9A	INTERGRAL DRIVE SHAFT	1	324-29xx-xxxN	19	WASHERS	4	391-3784-028N
9B	Continental Drive Shaft	1	324-xxxx-xxxN	20	NUT	4	391-1451-076N
10	GASKET SEAL	1 or more	391-2884-050N				