

IFF IP3500 PUMPS SERVICE PARTS INFORMATION

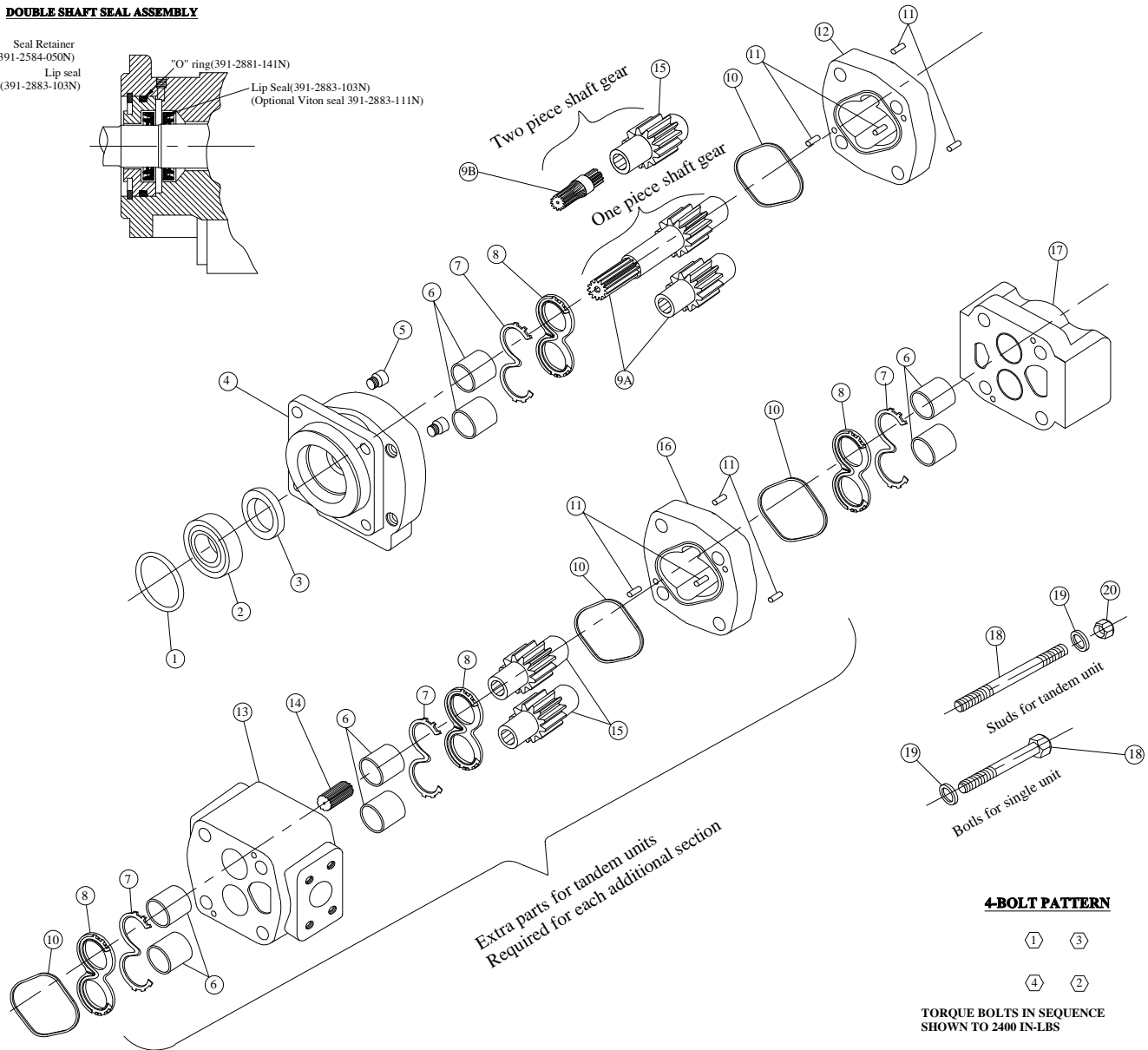

DOUBLE SHAFT SEAL ASSEMBLY

Seal Retainer
(391-2584-050N)
Lip seal
(391-2883-103N)

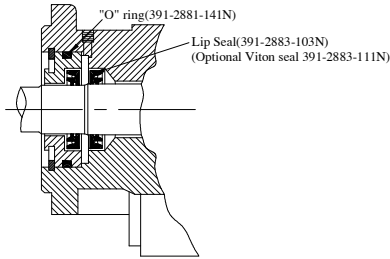

4-BOLT PATTERN



TORQUE BOLTS IN SEQUENCE
SHOWN TO 2400 IN-LBS

DESCRIPTION & CODES

ITEM	DESCRIPTION	REQ'S	PART NO.	ITEM	DESCRIPTION	REQ'S	PART NO.
1	SNAP RING	1	391-2686-065N	11	DOWEL PINS	4 or more	391-2082-032N
2	OUTBOARD BEARING	1	391-0381-077N	12	GEAR HOUSING	1	323-81xx-100N
3	SEAL	1	391-2883-103N	13	BEARING CARRIER	1	323-7xxx-100N
4	SHAFT END COVER	1	323-5xxx-xxxN	14	CONNECTING SHAFT	1	323-1133-100N
5	PLUG	2	391-2886-004N	15	MATCHED GEAR SET	1	323-28xx-000N
6	BUSHINGS	4 or more	391-0482-308N	16	GEAR HOUSING	1	323-81xx-100N
7	CHANNEL SEAL	4 or more	391-2885-066N	17	PORT END COVER	1	323-3xxx-100N
8	THRUST PLATES	4 or more	391-2185-957N	18	CAP SCREWS & STUDS	4	xx-BOLTS-xx IN
9A	INTERGRAL DRIVE SHAFT	1	323-29xx-xxxN	19	WASHERS	4	391-3784-028N
9B	Continental Drive Shaft	1	323-xxxx-xxxN	20	NUT	4	391-1451-076N
10	GASKET SEAL	2 or more	391-2884-074N				