

# IFP IP3650 PUMPS SERVICE PARTS INFORMATION

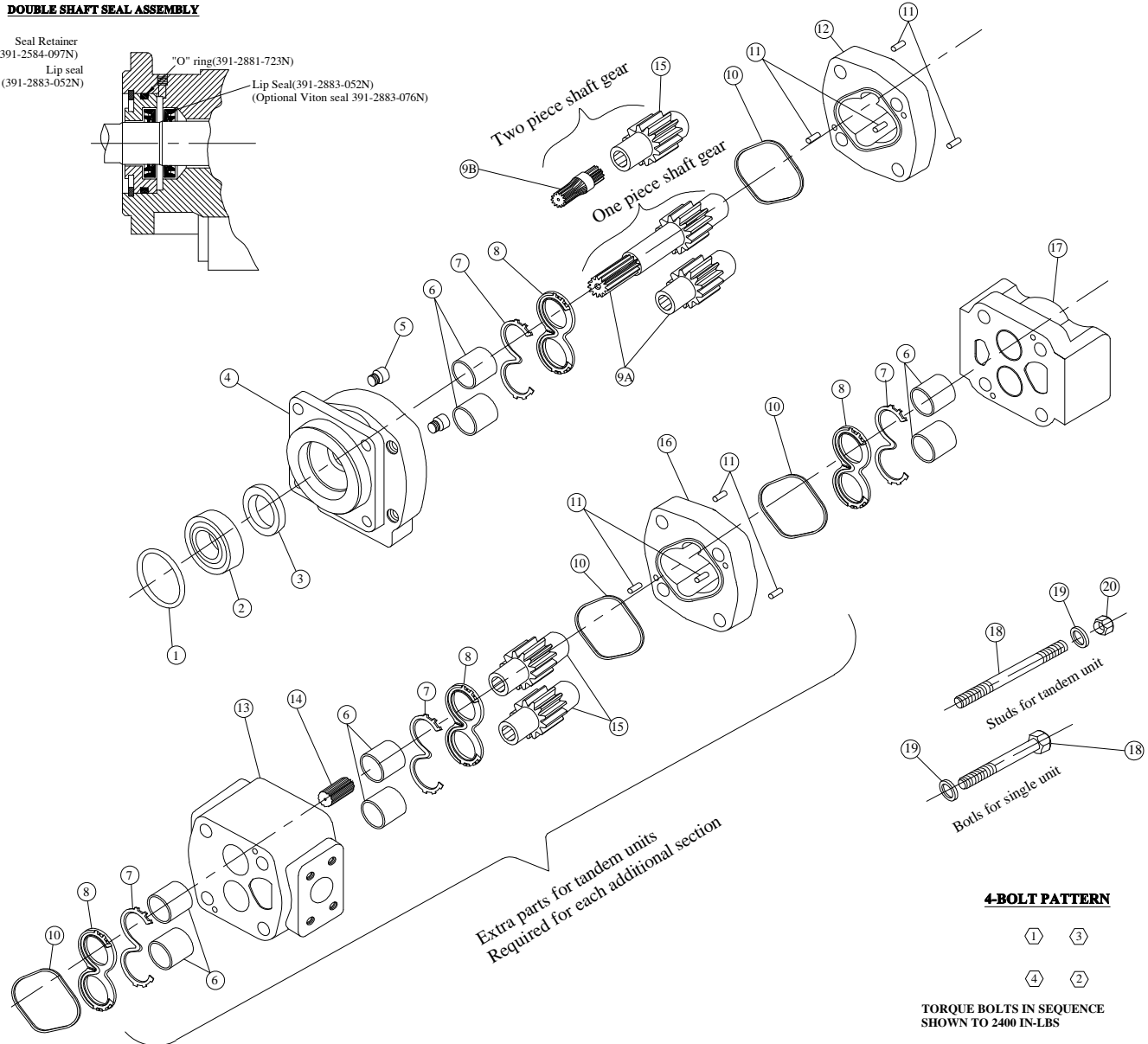

## DOUBLE SHAFT SEAL ASSEMBLY

Seal Retainer  
(391-2584-097N)  
Lip seal  
(391-2883-052N)

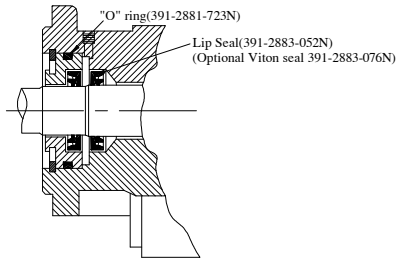

### 4-BOLT PATTERN



TORQUE BOLTS IN SEQUENCE  
SHOWN TO 2400 IN-LBS

## DESCRIPTION & CODES

ITEM	DESCRIPTION	REQ'S	PART NO.	ITEM	DESCRIPTION	REQ'S	PART NO.
1	SNAP RING	1	391-2686-025 N	11	DOWEL PINS	4 or more	391-2082-062N
2	OUTBOARD BEARING	1	391-0381-078N	12	GEAR HOUSING	1	322-81xx-100N
3	SEAL	1	391-2883-052N	13	BEARING CARRIER	1	322-7xxx-100N
4	SHAFT END COVER	1	322-5xxx-xxxN	14	CONNECTING SHAFT	1	322-1133-001N
5	PLUG	2	391-2286-004N	15	MATCHED GEAR SET	1	322-28xx-000N
6	BUSHINGS	4 or more	391-0482-307N	16	GEAR HOUSING	1	322-81xx-100N
7	CHANNEL SEAL	4 or more	391-2885-064N	17	PORT END COVER	1	322-3xxx-100N
8	THRUST PLATES	4 or more	391-2185-955N	18	CAP SCREWS & STUDS	4	xx-BOLTS-xx IN
9A	INTERGRAL DRIVE SHAFT	1	322-29xx-xxxN	19	WASHERS	4	391-3784-028N
9B	Continental Drive Shaft	1	322-xxxx-xxxN	20	NUT	4	391-1451-076N
10	GASKET SEAL	1 or more	391-2884-052N				